

To: _____

Return to: TONY HAUCK Fax 800 988 9896

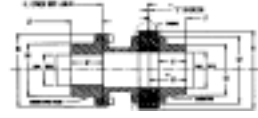

ATRA-FLEX® Coupling Application Data Sheet

110 East Garry Ave. • Santa Ana, CA 92707

Tel. (800) 443-6613 • Fax (800)988-9896

Company: _____
Address: _____

Date: _____
Phone: _____
Fax: (important) _____
Response Req'd by: _____
Submitted by: _____

Coupling Orientation:

Horizontally Mounted
Vertically Mounted

Coupling Type:

Nonspacer Flywheel
Horizontal Shear Spacer Shaft Gap: _____
Limited End Float (**for sleeve bearing motors**)

Section I - Prime Mover

Type: Electric Motor Hydraulic

Engine (No. of Cyl.) _____ Turbine
Diesel Gas Steam Air

Rating (HP) : _____ RPM: _____ Torque: _____ Shaft: _____
Driven Shaft: _____ Taper Shaft * Spline Shaft *

Section II- Application Data

Description: _____

Load Characteristics:
Unidirectional Reversing
Smooth Light Shock Heavy Shock
Little Vibration Med. Vibration Hvy. Vibration
Gear Box Ratio: _____
Input RPM: _____ Shaft Size: _____
Output RPM: _____ Shaft Size: _____

Duty Cycle: Continuous Intermittent

Number of stops & starts: _____/24 hrs.

Environmental Concerns (Temperature, Moisture, Dust, Corrosive Materials) : _____

Section III- Coupling Selection Data & Rating

Quote number _____

Input Side

Coupling size: _____
Coupling max rpm: _____
HP: Continuous: _____
Intermediate: _____
Balance for _____ rpm

Distance between shaft ends/Shaft Gap: _____
Taper Shaft Spline Shaft
Driver shaft diameter: _____ Key: _____
Slip Fit Interference Fit
Driven Shaft Diameter: _____ Key: _____
Slip Fit Interference Fit

Price Consumer: _____

Output Side

Coupling size: _____
Coupling max rpm: _____
HP: Continuous: _____
Intermediate: _____
Balance for _____ rpm

Distance between shaft ends/Shaft Gap: _____
Taper Shaft Spline Shaft
Driver shaft diameter: _____ Key: _____
Slip Fit Interference Fit
Driven Shaft Diameter: _____ Key: _____
Slip Fit Interference Fit

Price Consumer: _____

* Please request form **Tldata** or **Spdata** to specify taper or spline dimensions.